

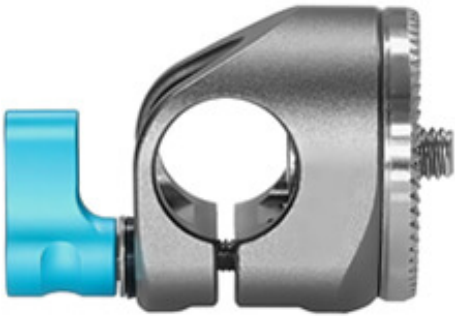

Kondor Blue Rosette to Straight Angle Rod Clamp

ProdCode: KONRPRC

Rosette To Perpendicular 15mm Rod Clamp - Space Grey



[\[Download Images\]](#) (.zip file)

Features

- Rosette To Perpendicular 15mm Rod Clamp
- This camera rod clamp gives your 15mm rods a functional mount
- Lightweight and durable
- Aerospace-Grade Aluminum
- Toolless 15mm rod connection
- Standard ARRI-style rosette (60 teeth) w/ M6 threading
- Mounting: Rod Clamp, ARRI-style rosette w/ M6 threading
- Dimensions: 32mm L x 32mm W x 42mm T (to top of knob)
- Weight: 60g/2.1 oz
- Thread Depth: 8mm

The all-new KONDOR BLUE Reversible Rosette Extension Arms are made for users of any level from run-n-gun solo creators to Hollywood DP's and camera operators. The KONDOR BLUE Rosette to Straight Angle Rod Clamp is an essential rigging accessory with loads of potential applications from EVF mounting to grips. Unlike other options on the market, this bit offers several ways to mount and use. The kit comes with a custom M6 bolt to mount into other ARRI-style accessories. When removed, the rosette has M6 female threads for mounting accessories into the clamp.

This clamp is an especially compelling option for mounting grips directly to your 15mm rods, because the rod clamp is centered about the rosette center axis. This better balances the load on the clamp as well as providing a more consistent experience when rotating or tilting the grips. It's also a great option for mounting EVF's or other rosette-based accessories.

KONDOR BLUE also offers a range of 15mm rods and rosette accessories.

